

Do not scale from this drawing for construction or acquisition purposes. Responsibility is not accepted for errors made by others in scaling from this drawing. All construction information must be taken from figured dimensions only. All dimensions and levels must be checked on site and discrepancies between drawings and specification must be reported to GSSArchitecture. © Copyright GSSArchitecture.

Ordnance Survey © Crown Copyright 2013. All rights reserved. Licence number GSS 100017356.

Map Data Copyright 2013 Google.

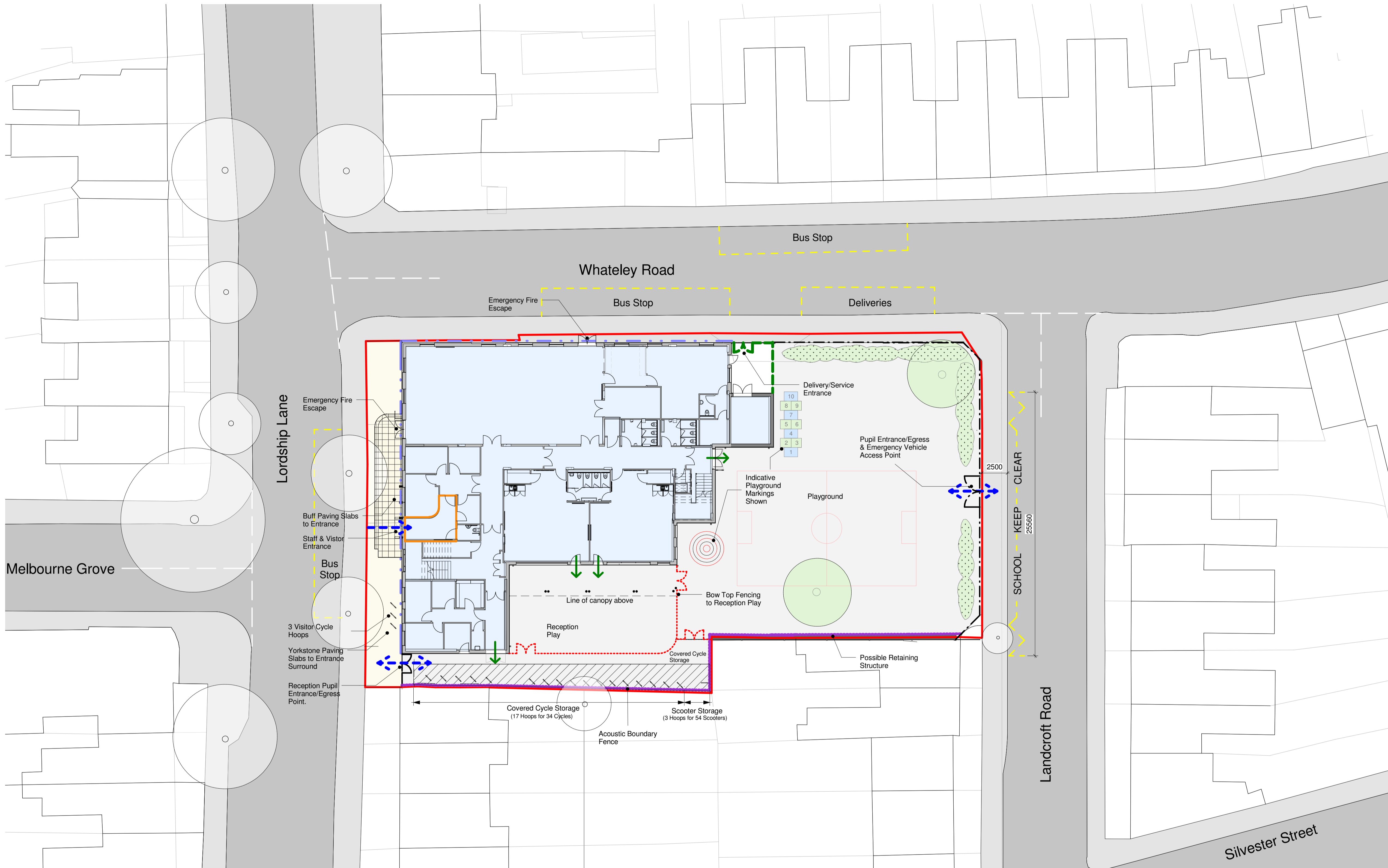

I	08/05/15	RCG	PEH	Footpath and Parking to Landcroft Road updated to reflect TPA proposal
H	06/05/15	RCG	PEH	Amendments to parking and pavements on Landcroft Rd
G	23/04/15	RCG	PEH	Playground entrance on Whateley Road omitted & hedgerow extended according
F	13/04/15	RCG	PEH	Visitor Cycle Hoops reinstated
E	13/04/15	RCG	PEH	Updated following client comments
D	13/04/15	RCG	PEH	Revised Scheme
C	08/12/14	BPG	PEH	Reception play canopy amended
B	05/12/14	BPG	PEH	Pedestrian gate text amended
A	01/12/14	BPG	PEH	Updated plans from DUG 5

Rev.	Date	Drawn	Check	Description
------	------	-------	-------	-------------

GSSARCHITECTURE

35 HEADLANDS, KETTERING, NORTHANTS, NN15 7ES
 Telephone: 01536 513 165, Fax: 01536 410 226
 Email: gss@gotch.co.uk, Web: www.gssarchitecture.com

Bristol: 01275 378 310, Harrogate: 01423 815 121

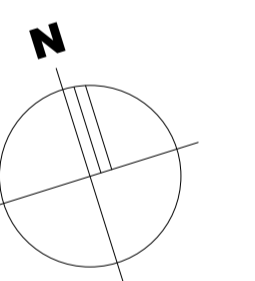

This drawing is purely for discussion purposes only. It is not to be taken as a proposal for construction detailing, and instead it is primarily intended to convey the overall spatial layout of the building or parts of it. Please refer to the developed production information drawings for detail, construction and measurement purposes.

PRELIMINARY ISSUE

Project Title:
 East Dulwich Primary Harris Free School

Client:
 Farrans Construction

Drawing Title:
 Proposed Site Plan

File Number: Sch250

Drawn By: BPG

Checked By: PEH

Scale@A1: As indicated **Date:** 07-11-14

Dwg No: (SK)100 **Rev:** I

1. Proposed Site Plan
1 : 200@A1

KEY

	Existing Trees		Line shows primary security line within school.		Buff Paving Slabs		Acoustic Boundary Fence		2m high welded wire boundary fence
	Proposed Trees		Site Boundary		Yorkstone Paving Slabs		Circulation		800mm high Bow top fencing for edge of reception play
	Proposed Perimeter Hedgerow		Indicates where building forms secure line		Tarmac		Pedestrian Entry Points		2m high Timber close boarded fence



Example of mesh welded wire boundary fence

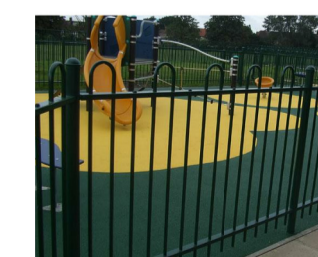

Example of bow top fencing for reception play perimeter

Note:
 Refer to Electrical Engineer's Drawing for external lighting proposals
 To be read in conjunction with civil engineers details and for coordination of all levels